

PINPOINT BRASS - PROPANE TORCH

Part Number: 206067

INSTRUCTION MANUAL

FAILURE TO COMPLY WITH THESE INSTRUCTIONS AND WARNINGS MAY RESULT IN DAMAGE TO PROPERTY, SERIOUS PERSONAL INJURY OR DEATH.

Torch to be used with propane only. Use only with Disposable Propane Cartridges specifically designed for use with torches.

Read and comply with the instructions and warnings in this manual and familiarize yourself with the torch before igniting and using. Review instructions and warnings periodically to maintain awareness. Do not try to operate before reading instructions. When using torches, basic safety precautions should always be followed.

WARNING

- Before using, check all parts for proper function and damage to component parts.
- Keep torch out of reach of children. Do not permit anyone to use this torch who has not read this manual.
- Only use the torch in an upright position. Never use this torch upside down. The propane cartridge contains gaseous and liquid propane. If the torch is moved rapidly, tilted too far to the side or upside down, the liquid can enter the valve and cause the flame to flare or extinguish.
- Keep a fire extinguisher near where you are using the torch and where you store the torch.
- Always point the torch flame away from your body, other persons and flammable objects. Check to make sure no unintended materials have been heated. Never attempt to use torch as a cigarette lighter.
- ALWAYS disconnect torch from cartridge when not in use.
- Do not attempt to modify the torch construction and never use unapproved accessories or fuels.
- Unauthorized servicing is prohibited.
- Be cautious when using the torch outdoors on sunny or windy days. Bright sun makes it difficult to observe the flame. Wind may misdirect the flame towards you or other unintended areas or objects. Wind may further cause sparks to come in contact with unintended combustible materials.
- Do not drop or otherwise abuse the torch.
- Do not use a torch that is leaking, damaged or malfunctioning.
- Radiant energy can harm your eyes. Wear goggles complying to Australian Standard AS/NZS 1338, with a shade 5 glass filter lens.
- Work only in well-ventilated areas. The fumes from fluxes, cadmium plating, brass, zinc and galvanized metal are toxic.
- Hidden areas such as behind walls, ceilings, floors, and

other panels may contain flammable materials that could be ignited by the heat gun when working in these locations. The ignition of these materials may not be readily apparent and could result in property damage and injury to persons. When working in these locations, keep the torch moving in a back-and-forth motion. Lingering or pausing in one spot could ignite the panel or the material behind it.

- Never use torch to strip lead paint.
- Avoid contact of flux with eyes or skin.
- Always wear protective gloves.
- Be aware that the tip of the torch can get extremely hot during use.
- Be careful around motor vehicles or any fuel-fired products and beware of any hidden fuel lines and tanks.
- Always make certain the torch is placed on a level surface when connected to a fuel cartridge to reduce the risk of accidental tip over.
- Never use the torch on or near an aerosol can or any container that contains or previously contained chemicals, or flammable materials, liquids or gases. Heating these is extremely dangerous, especially after they have been emptied.
- Never leave the torch unattended when lit.
- This torch consumes oxygen and must only be used in well ventilated areas. Do not use in a confined work area or enclosed space.

DANGER

- This torch uses Propane Fuel in a pressurized cartridge. **PROPANE IS EXTREMELY FLAMMABLE.**
- Keep propane cartridge away from heat or flame.
- It is illegal and dangerous to refill the cartridge. When empty, obtain a new cartridge from your dealer.
- Keep propane cartridge out of reach of children.
- Avoid prolonged exposure to sunlight.
- Do not store near source of heat or in a room used for habitation.
- **ALWAYS DETACH TORCH FROM CARTRIDGE WHEN NOT IN USE.**
- Do not breathe gas, fumes, vapor or spray. If inhaled, remove affected person to fresh air.
- Avoid contact with eyes or skin. In case of contact with eyes, rinse immediately with plenty of water and seek medical advice. For skin contact, flush with large amounts of water.
- When cartridge is empty: discard in a safe place.
- Do not throw cartridge in fire.
- Do not puncture or incinerate cartridge.

COMPONENTS

COMMANDTOOLS

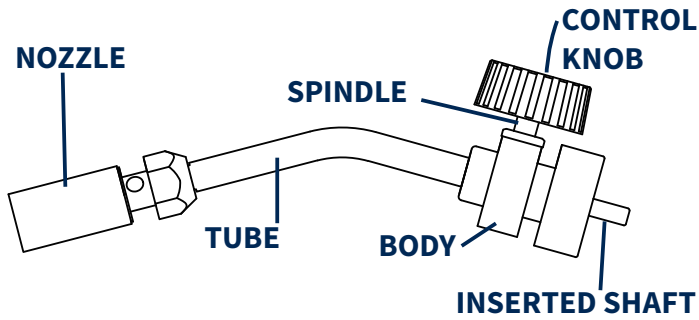

ASSEMBLY

1. Make sure valve is **OFF** by turning knob in direction of arrow (clockwise) until hand tight only. **DO NOT FORCE.**
2. Turn fuel cartridge clockwise into valve body until hand tight. **DO NOT FORCE.**

STEP 1

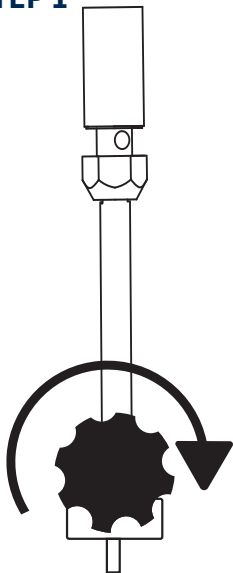

LIGHTING AND OPERATION

1. To light with a match, hold as shown and open valve slowly. $\frac{1}{4}$ turn is normally enough.
2. To light with hand sparker, open valve slowly before sparking, $\frac{1}{4}$ turn is normally enough.
3. Hold hand sparker at a 45° angle to the torch opening. **NOTE:** It is very difficult to light with valve fully open.
4. For hottest, most efficient flame, adjust inner blue flame of pencil burner to 4-5 cm in length.
5. If ignition does not occur immediately upon opening the torch valve, close the valve and wait 5 minutes before attempting to ignite again. Failure to follow this instruction could result in a build up of flammable gas which if ignited could result in a fireball that could cause injuries and property damage. Do not open the valve and allow gas to flow through the torch without attempting to ignite the torch.

STEP 2

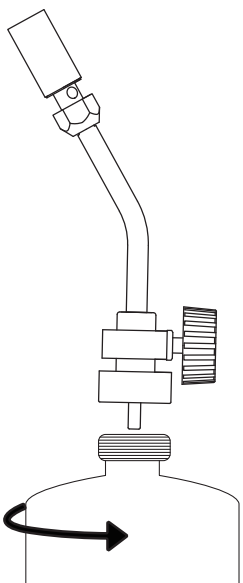

ADDITIONAL WARNINGS

Make sure torch is cool before tightening or removing burner head, or before installing or removing accessories.

Check all joints and couplings periodically to insure against loose connections. With valve open, without lighting, test all connections with leak detection spray or soapy water. If bubbles appear, gas is leaking and torch must be repaired. Never Use a flame to check for leaks. Make this test in a well-ventilated and spark-free area, and where there are no open flames.

In cold weather the size of the flame will be smaller. To produce a larger flame, pre-warm the cartridge to room temperature prior to use.

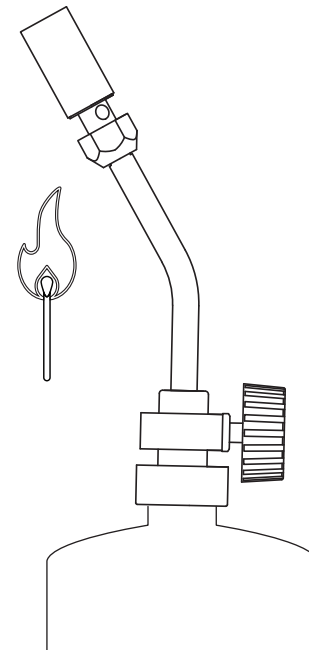

ADDITIONAL NOTE: As a safety feature, the burner may snap if the torch is dropped, in which case the burner must be replaced.

STORAGE

ALWAYS REMOVE CARTRIDGE FROM TORCH WHEN NOT IN USE

1. Make sure valve control knob is closed by turning fully clockwise until it stops. Do not force.
2. When torch is cool, disconnect cartridge and store torch and cartridge separately and out of reach of children. Observe cautions on cartridge label.
3. Do not expose cartridges to temperatures in excess of 49°C .
4. Store cartridges in well ventilated areas.

**SAVE THESE INSTRUCTIONS
DO NOT DISCARD
THESE WARNINGS AND
INSTRUCTIONS**

DISTRIBUTED BY
TRADEPEM INDUSTRIAL PTY LTD
WWW.COMMANDTOOLS.COM.AU