

# Tradeflame®

## SOLDERING STATION PRODUCT MANUAL

PART NO. 218156

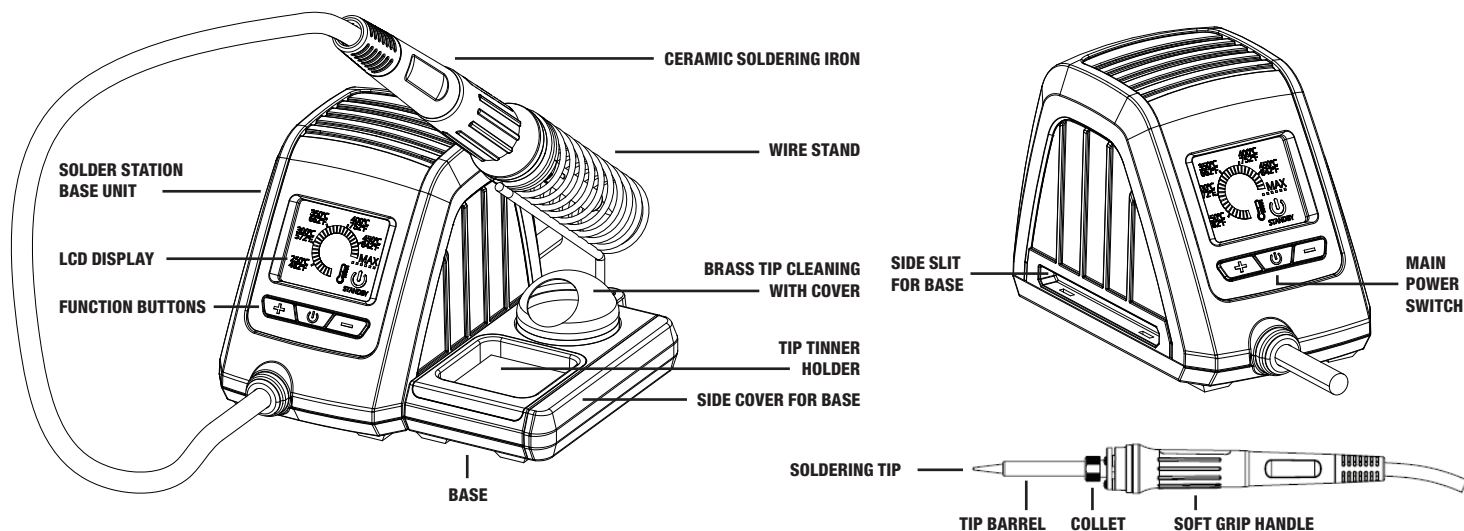

**IMPORTANT: READ THESE INSTRUCTIONS FOR USE CAREFULLY. FAMILIARISE YOURSELF WITH THE APPLIANCE BEFORE CONNECTING TO POWER SOURCE. KEEP THESE INSTRUCTIONS FOR FUTURE REFERENCE.**



**CAUTION:** For maximum protection, always wear safety goggles, gloves or other appropriate equipment

### PARTS LIST

1. Ceramic soldering iron
2. Wire stand
3. Brass tip cleaner with cover
4. Tip tinner holder
5. Side cover for base
6. Base
7. Solder station base unit
8. LCD display
9. Function buttons
10. Main power switch
11. Side slit for base
12. Soldering tip
13. Tip barrel
14. Collet
15. Soft grip handle

### LCD DISPLAY AND BUTTON FUNCTIONS

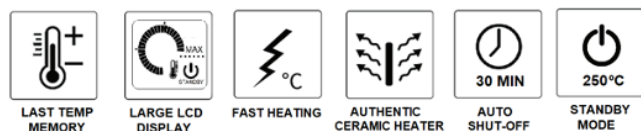

### CAUTION

The tool reaches high temperature! May cause burn.

### WARNING

This tool must be placed on its stand when not in use.

### IF THE TORCH OVER-TILTS BEYOND A SAFE ANGLE

1. Do not touch hot tip or hot metal parts when in use.
2. We strongly urge users to always rest a hot iron on the stand to prevent risk of fire. If the stand is not used, the heated tip will tilt and may burn any objects that come in contact which will result in a fire hazard.
3. Keep out of reach of children.
4. Misuse may cause burns, electric shock and injuries.
5. Do not immerse tool in water or other liquid! Danger of electric shock!
6. Always use the tool on a heatproof and uncluttered table.
7. After finished using the tool, let the tool cool naturally on safety stand in a safe place, out of reach of children.
8. If the supply cord is damaged, it must be replaced by the manufacturer, its service agent or similarly qualified persons in order to avoid a hazard.
9. Cleaning and user maintenance shall not be made by children without supervision.
10. Children should be supervised to ensure that they do not play with the tool.
11. This appliance is not intended for use by persons (including children) with reduced physical, sensory or mental capabilities, or lack of experience and knowledge, unless they have been given supervision or instruction concerning use of the appliance by a person responsible for their safety.
12. For domestic use only. Use only for the intended purposes.

# TradeFlame®

## SOLDERING STATION PRODUCT MANUAL

PART NO. 218156

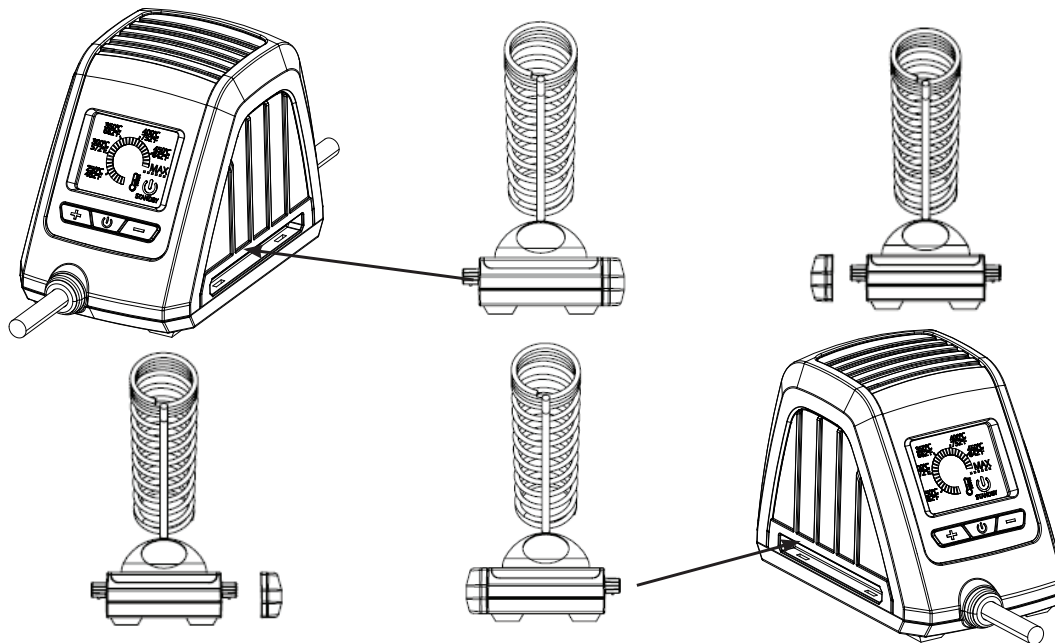

### INSTRUCTIONS FOR USE

#### 1. SETTING UP THE BASE AND STAND

- There are side slits on both sides of the soldering station base unit.
- Assemble the base into either side of the base unit according to your preference. Note the wire stand should be sitting at the back.
- Assemble the side cover onto the open side of the base unit to complete the assembly.

#### 2. BRASS TIP CLEANER AND TIP TINNER

- Place the brass tip cleaner on the back slot on the base, and install the brass tip cleaner cover on top, with the opening facing you. Brass tip cleaner is for cleaning the tip in between soldering.
- Place the tip tinner on the front slot on the base. Tip tinner is for removing oxidation on your tip to prolong tip life.

#### 3. SWITCHING ON

- Place the ceramic soldering iron in the wire stand.
- Check that the voltage of the unit is the same as the source of current.
- Connect power cord from the back of soldering station to the wall mains power.
- Use the main power switch on the back of the main unit to turn the station on.
- The soldering iron will then heat up to the tip temperature when it was last used, or to the factory setting at around 350°C for first use.

#### 4. HEATING STATUS BAR

- During a heating cycle, the heating status bar will flash slowly increasing in length, indicating the heater is on, and temperature is climbing. Once the desired temperature is reached, the bar will be off.
- During a cooling cycle (when desired temperature is set to a lower temperature), the heating status bar will flash slowly decreasing in length, indicating the heater is off, and temperature is dropping. Once the desired temperature is reached, the bar will be off.

#### 5. TEMPERATURE STATUS BAR

- The temperature status bar indicates the target temperature setting.
- Press the “+” button to increase the desired temperature.
- Press the “-” button to decrease the desired temperature.
- Each light segment represents a 10°C increment.

#### 6. STANDBY MODE

- To prolong tip life, during soldering idle time you can press the middle standby function button to manually trigger the standby mode.
- The standby mode icon will light up.
- Temperature will be lowered to 250°C.
- The temperature status bar will also reflect the standby temperature.
- To cancel the standby mode, simply press the middle standby function button again.
- The heating cycle will come on again, with heating status bar flashing slowly increasing in length, indicating the heater is on, and will resume to the last temperature setting before the standby mode.

#### 7. AUTO-OFF MODE

- Once entered the standby mode, if there is no activity in the function buttons for 30 minutes, the station will shut down automatically.
- The standby mode icon will flash slowly until the soldering iron reaches room temperature, in which all LCD display will be out.

#### 8. SOLDERING

- Surfaces of the connection points must be clean.
- Use the soldering iron to heat the connection points, not the solder.
- Apply only enough solder to the heated parts.
- Allow the joint to cool undisturbed.

#### 9. MAINTENANCE

- When there is residue on the soldering tip, insert the tip into the brass tip cleaner to remove any residue.
- To prolong the lifetime of the tip, dip a heated tip into the tip tinner paste, the chemical will remove any oxidation and the tip will come out clean and shiny.

#### 10. SWITCHING OFF

- After soldering, switch off the soldering iron by turning the main power switch at the back of the main unit to off.
- Unplug the soldering iron and let it cool down naturally on the stand.

#### 11. CHANGING SOLDERING TIP

- Ensure soldering iron has completely cooled down before changing soldering tip.
- Simply unscrew the collet and the tip barrel.
- Remove existing soldering tip, and insert a new soldering tip.
- Replace the tip barrel and collet, and screw the collet tight.